

SRN

SINGLE SPRING SEAL

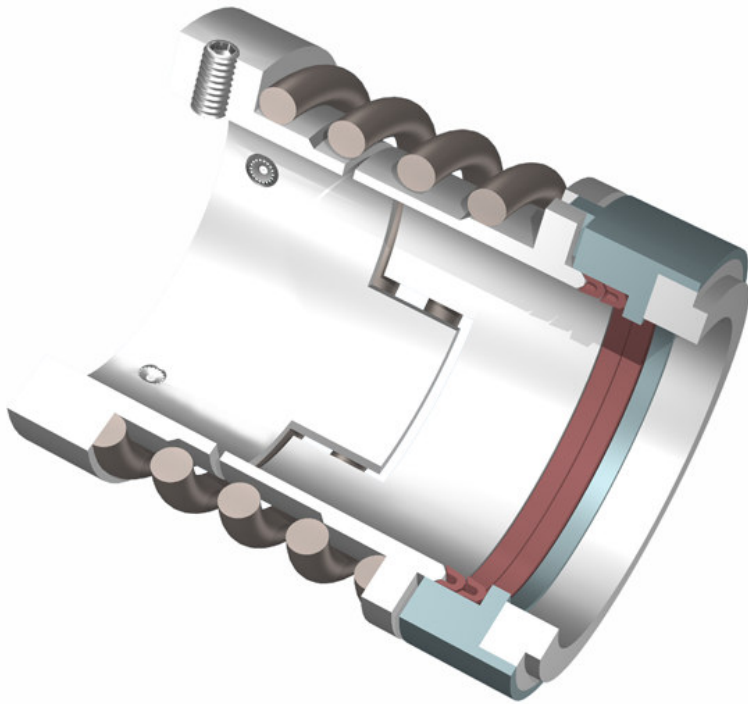

- **STURDY & RUGGED DESIGN**
- **RELIABLE PERFORMANCE**
- **BI-DIRECTIONAL POSITIVE DRIVE**
- **FITS ANSI, ISO & DIN PUMPS**
- **METRIC SIZE CONFIRM TO EN12756 (L1N)**
- **EASY TO INSTALL**

HI-FAB SRN seals are simple in construction & are easy to install. They are most suited for the applications where crystallizing solutions are handled. SRN seals are single spring seals which are independent of the direction of rotation due to unique positive drive lug design. Secondary elastomers in PTFE are spring energized.

Helix of the spring has a cleaning effect in the seal area which does not allow slurry particles to settle down permanently between flexible member of the seal and the shaft. The heat distribution inside the stuffing box is thus more uniform due to impeller action of the spring.

APPLICATIONS :

- **VISCOUS & ARDUOUS DUTIES**
- **CRYSTALLIZING & SOLIDIFYING MEDIA**
- **ABRASIVE SLURRIES UPTO MODERATE CONCENTRATIONS**
- **HEAT TRANSFER LIQUIDS UPTO MODERATE TEMPERATURES (280°C)**



INSTALLATION DIMENSIONS

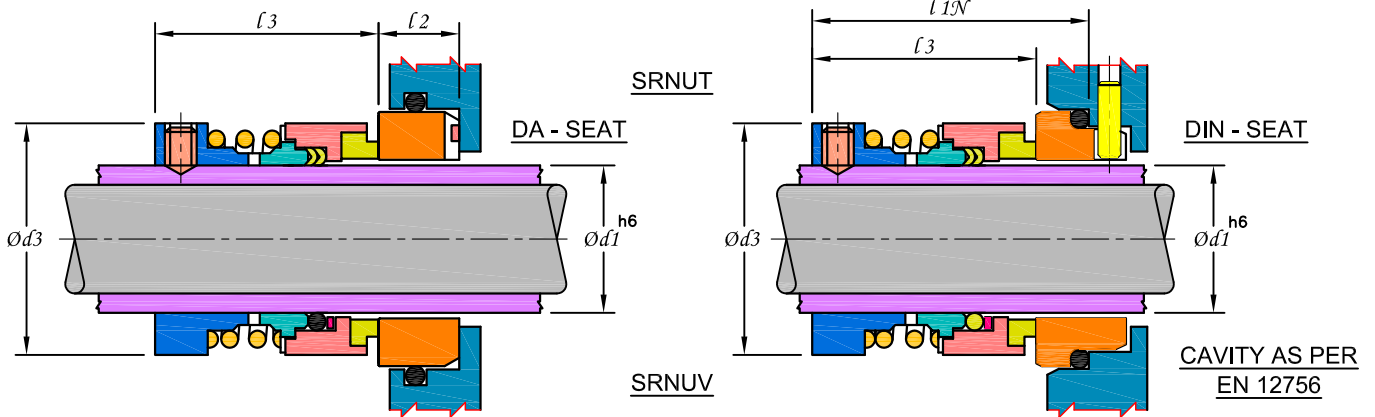

INCH SIZES

SIZE CODE INCH	d1	d3	l3	l2
0254	25.40	39.70	39.50	12.7
0285	28.57	42.90	39.50	12.7
0317	31.75	46.10	39.50	12.7
0349	34.92	49.20	44.50	12.7
0381	38.10	52.40	44.00	12.7
0412	41.27	55.60	44.00	12.7
0444	44.45	59.90	49.00	12.7
0476	47.62	63.10	49.00	12.7
0508	50.80	66.30	46.00	12.7
0539	53.97	69.80	56.00	14.3
0571	57.15	73.00	56.00	14.3
0603	60.32	76.20	56.00	14.3
0635	63.00	79.40	56.00	14.3
0666	66.67	86.20	66.00	15.9
0698	69.85	89.40	65.00	15.9
0730	73.02	92.50	65.00	15.9
0762	76.20	95.70	65.00	15.9
0793	79.37	100.1	74.00	15.9
0825	82.55	104.5	74.00	15.9

METRIC SIZES

SIZE CODE MM	d1	d3	l1N
0250	25.00	39.70	50.0
0280	28.00	42.90	50.0
0300	30.00	46.10	50.0
0320	32.00	46.10	55.0
0330	33.00	49.20	55.0
0350	35.00	49.20	55.0
0380	38.00	52.40	55.0
0400	40.00	55.60	55.0
0430	43.00	59.90	60.0
0450	45.00	59.90	60.0
0480	48.00	63.10	60.0
0500	50.00	66.30	60.0
0530	53.00	69.80	70.0
0550	55.00	73.00	70.0
0580	58.00	73.00	70.0
0600	60.00	76.20	70.0
0630	63.00	79.40	70.0
0650	65.00	86.20	80.0
0680	68.00	89.40	80.0
0700	70.00	89.40	80.0
0750	75.00	95.70	80.0
0800	80.00	100.1	90.0

LIMITING PARAMETERS

PRESSURE
UPTO 16 BAR

TEMPERATURE
-20°C TO 280°C DEPENDING UPON ELASTOMER

SPEED
26 m/sec ≤ 3000 rpm

MATERIALS

METAL PARTS
SS316 ALLOY-20 HASTELLOY-C

FACE COMBINATIONS	
ROTARY	STATIONARY
CARBON	CERAMIC / SIC / TC
SIC	SIC / TC
TC	SIC / TC

ELASTOMERS
VITON, EPR PTFE, GFT, FEP AFLAS, FFKM

DESIGN VARIATIONS

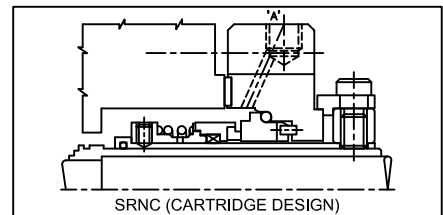
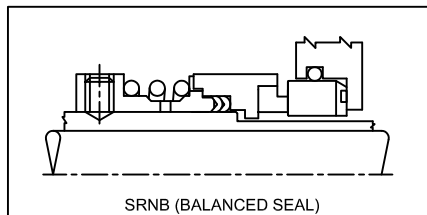
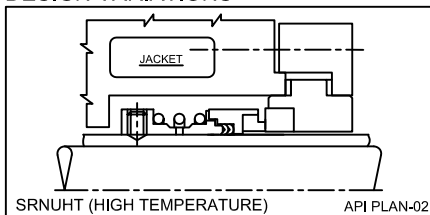

Registered Trademarks : Viton - Du Pont, Hastelloy - Haynes International, Inc. Kalrez - Du Pont Aflas - Asahi Glass Co.



HI-FAB ENGINEERS PVT. LTD.
 D-148, Bonanza Indl. Estate, Ashok Chakravarty Road,
 Kandivali (E), Mumbai - 400 101. INDIA.
 Tel. : +91 (0)22 2887 1173, 2887 9351, 2884 1278
 FAX: +91 (0)22 2887 0375, E-mail : info@hi-fab.com
 Website : http://www.hi-fab.com

